

Hugh Bowes

D-380

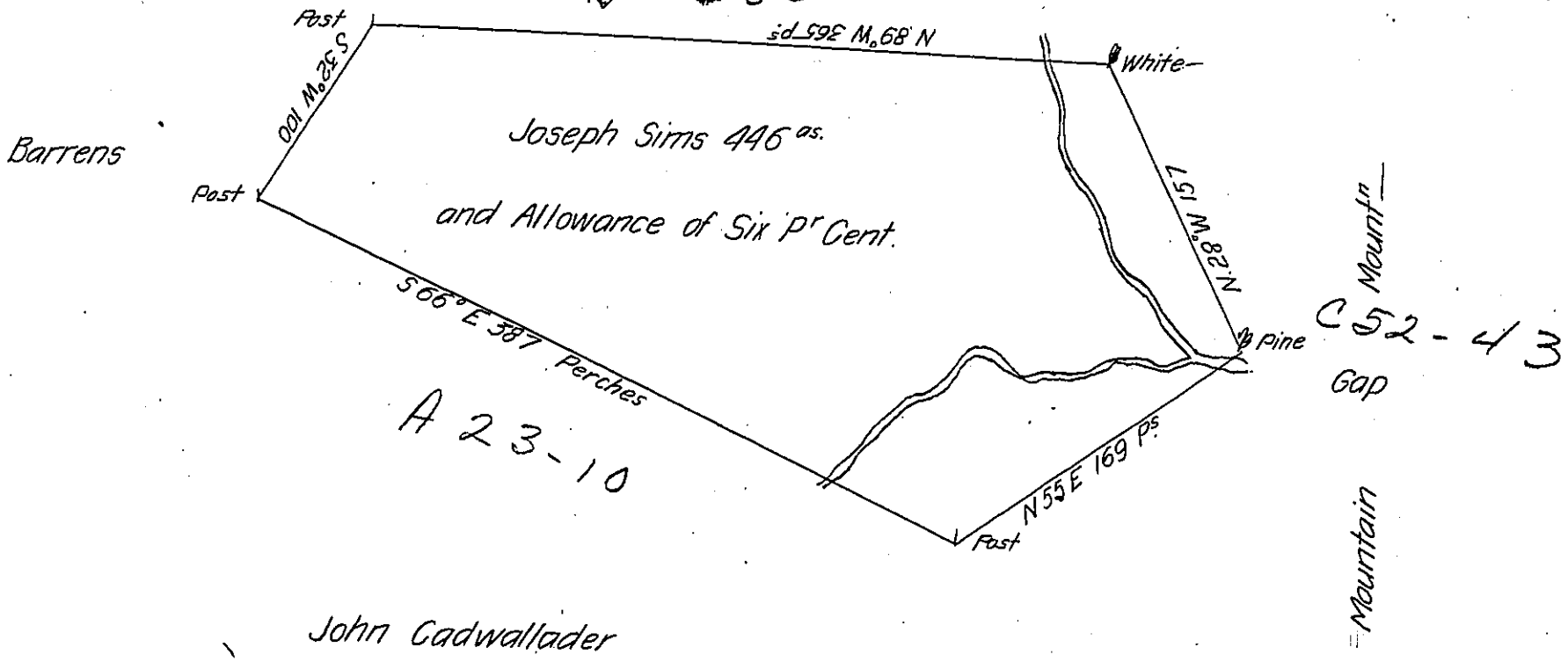

A Draught of a Tract of Land Situate at the Gap of Morrison's Cove Mountain on the Waters of Yellow Creek in the County of Cumberland, Containing four Hundred forty & Six Acres and the Usual Allowance of Six Acres P Cent for Roads &c. Survey'd in Pursuance of a Warrant granted Joseph Sims Dated the 25<sup>th</sup> Day of October one thousand Seven hundred and Sixty five.

To P. Richard Tea Dep<sup>y</sup> Survey<sup>r</sup>.

John Lukens Esq<sup>r</sup>.

Surveyor General.

now Woodberry towns. P Bedford C<sup>o</sup>.

IN TESTIMONY that the above is a copy of the original remaining on file in the Department of Internal Affairs of Pennsylvania, made conformably to an Act of Assembly approved the 16th day of February, 1833, I have hereunto set my Hand and caused the Seal of said Department to be affixed at Harrisburg, this Twenty-second day of November 1906

*Isaac P. Brown*  
Secretary of Internal Affairs.